

User Manual

For Mercedes



Android Auto



Apple CarPlay



Specifications

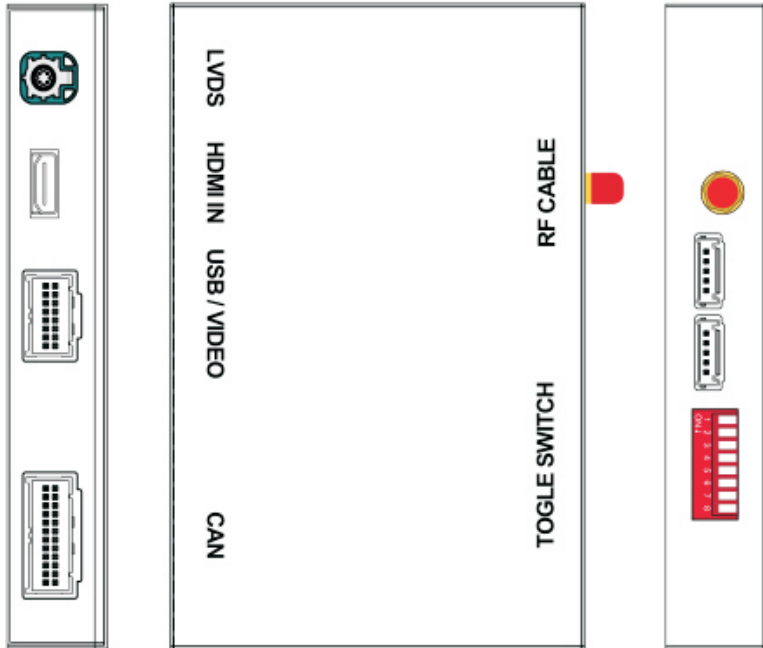

Panel description

CAN	For power cable connection, CAN data transmission
USB/Video	USB data transmission, and for reverse/front camera connection
HDMI IN	HDMI input, support up to 720P
LVDS	Connect with LVDS cable we provided
RF Cable	Wifi antenna connector
Toggle switch	Refer DIP code setting to set for different screen size

Specification

Input	USB/CVBS signal input
Input Voltage	12-16V DC
Rated Current	2A
Rated Power	24W
Control	Voice control, iDrive control
Material	Housing aluminum

Features

- >Support wireless/wired Carplay connection
- >Support wireless/wired Android auto function (some mobile phones)
- >Support wireless Airplay function
- >Support wired Autolink function
- >Compatible with OEM microphone and external microphone
- >Support EQ adjustment, lossless sound quality
- >Support HDMI input
- >Support USB to play audio file & video, support firmware upgrade
- >Keep the OEM system function, reversing radar and track display

Accessories For Benz 4.x/5.0 ntg BOX



LVDS cable



WIFI antenna



AV/USB cable



CAN power cable



**USB-to-AUX audio cable
(For Benz which has Burmester)**

Accessories For Benz 5.x ntg Box



LVDS cable



WIFI antenna



AV/USB cable



CAN power cable



Power amplifier box
(For Benz which has no Burmester)

DIP Code setting

Carplay box model	NTG	Screen size	DIP code setting	
4. x	4. 5	5. 8	00101101 (Priority of use)	
		5. 8	00101001	
		7	00100101	
5. x	5.0&5.1	6.3	00001001	
		7	00000001	
		8.4(800*480)	00000001	
		8.4(960*525)	00001101	
		12.3	00000101	
	4.7	6.3	6.3	00011001
			7	00010001
			8.4(800*480)	00010001
			8.4(960*525)	00011101
			12.3	00010101
	4.8	6.3	6.3	00111001
			7	00110001
			8.4(800*480)	00110001
			8.4(960*525)	00111101
			12.3	00110101

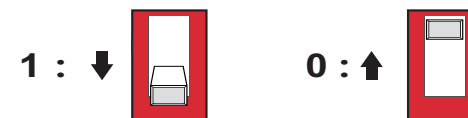
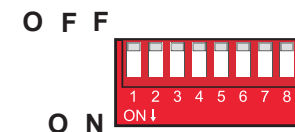

NTG4.5

Radio interface



Center console



NTG4.7/4.8/5.0/5.1

Radio interface



Center console



Connection Diagram

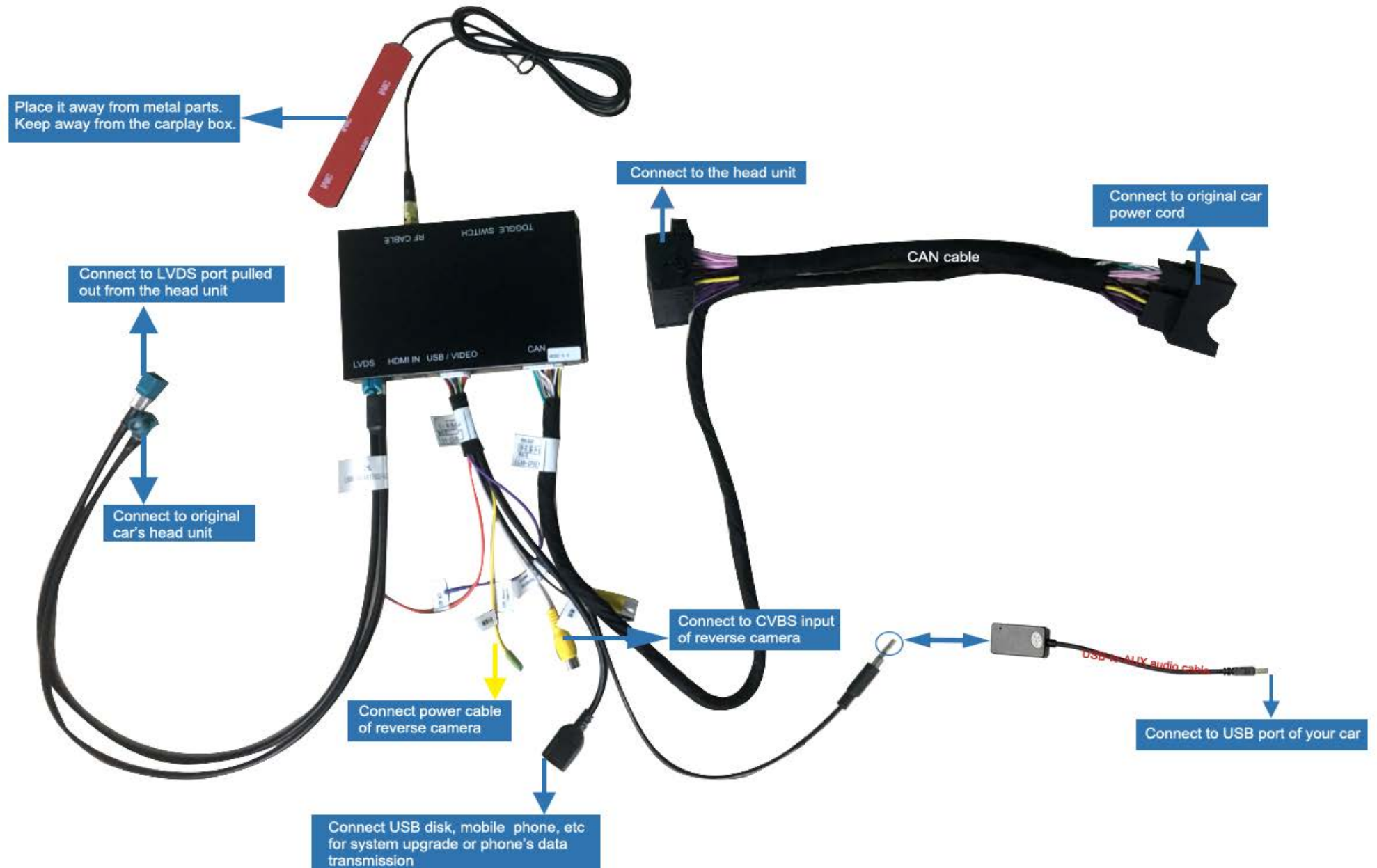

Reverse camera wiring connection and settings

Automatic transmission:

1. Connect the reverse camera to CVBS OUT labeled 'Reverse camera'
2. Connect the cable labeled '12V reverse camera(yellow)' to camera power
3. Setting → Reverse → Reverse camera → Aftermarket

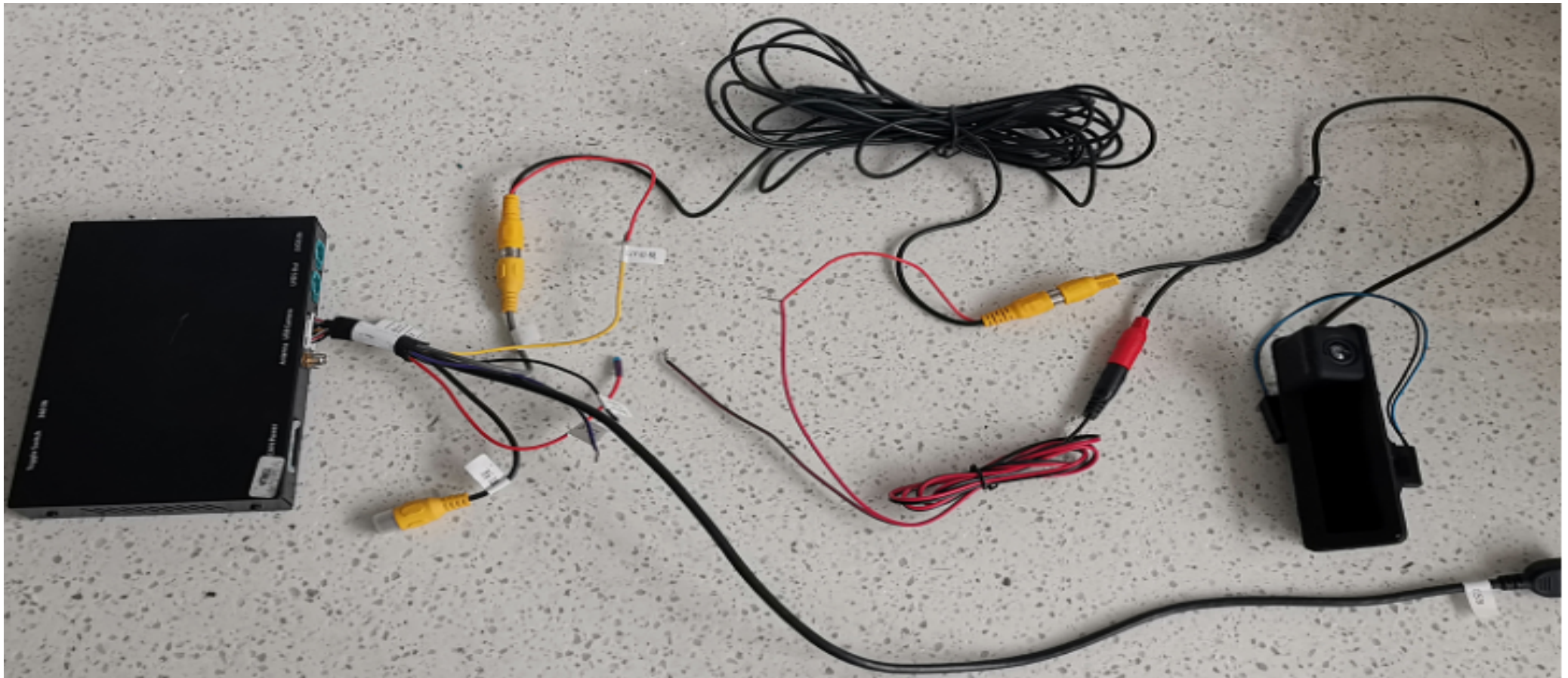
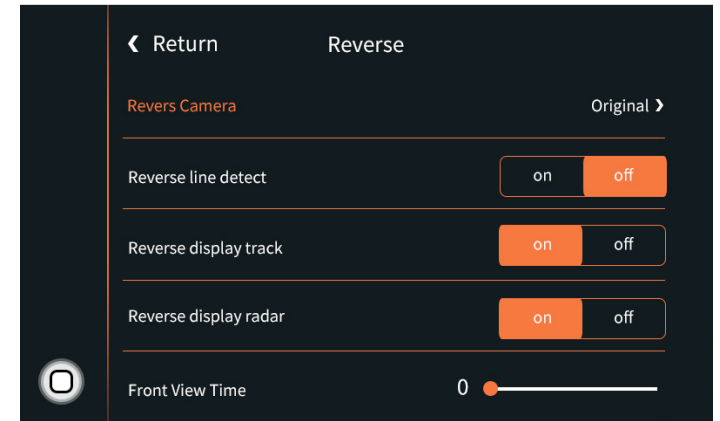

Munal transmission

1. Connect the reverse camera to CVBS OUT labeled 'Reverse camera'
2. Setting → Reverse → Reverse camera → Aftermarket

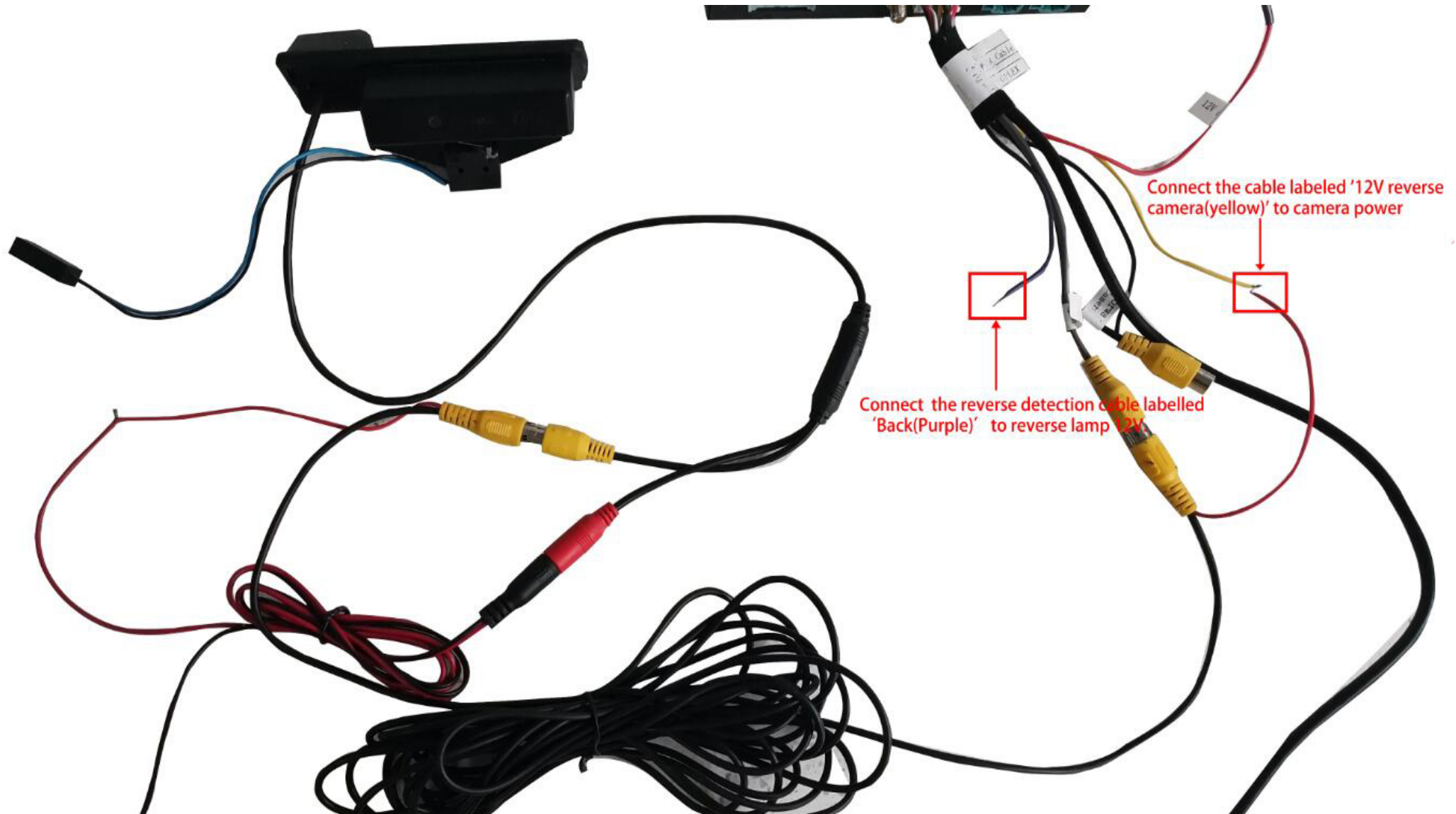
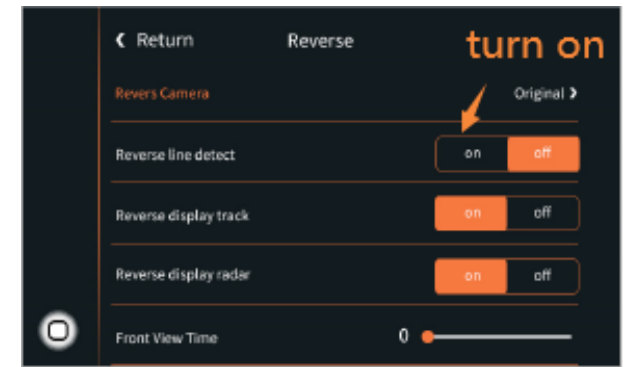

Wireless carplay connection

1. Turn on WIFI (Fig.1)
2. Turn on Bluetooth (Fig.2), and connect Carplay's bluetooth (Fig.3/4)
3. After the bluetooth connection is completed, the following prompts will pop up, click 'Allow-Use carplay' (Fig.5/6)

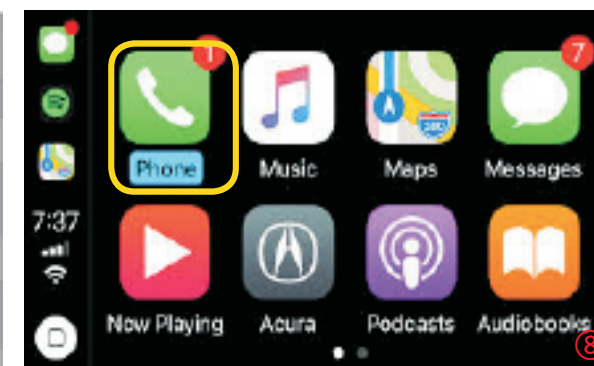
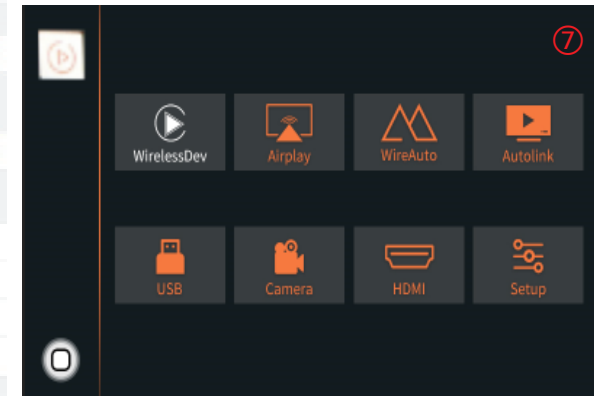

4. After the connection is successful, it will enter Carplay automatically(Fig.7/8)

Wireless Android auto connection

1. Turn on WIFI (Fig.1)
2. Turn on Bluetooth (Fig.2)
3. Search the Android phone's bluetooth on the screen in Carplay system(Fig.3/4/5)
4. Pair the bluetooth with your phone.(Fig.6)
5. After connecting the bluetooth, it will pop up the following prompts(Fig.7/8)
6. Then it will enter Android auto automatically(Fig.9)

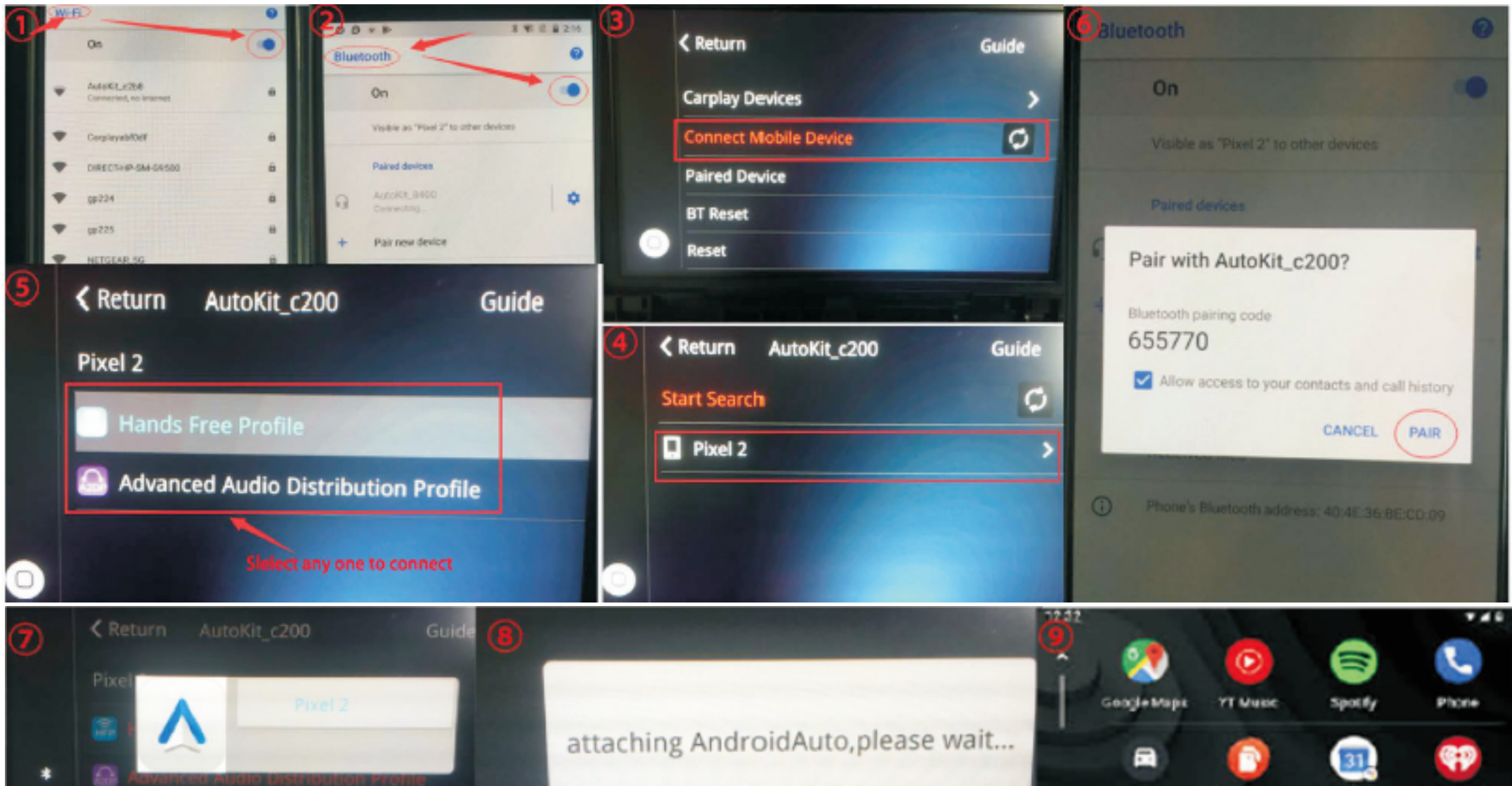

Wired Android auto connection

1. Download Android auto APP on your Android phone(Fig.1).
2. Click 'WireAuto' icon(Fig.2), the prompt 'Please connect your Android device' will pop up(Fig.3).
3. Plug your phone to USB port. then it will enter Android auto automatically(Fig.4).

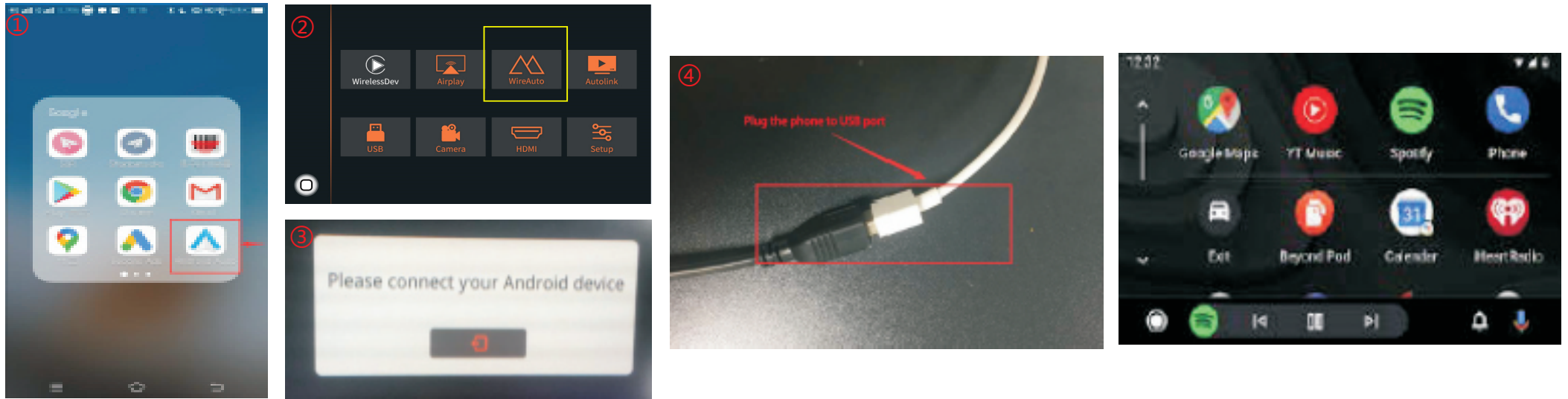

Wireless Airplay connection

1. Click 'Airplay' icon first (Fig.1), the pairing information with the phone will be displayed (Fig.2)
2. Search wifi signal of Airplay and connect
3. Turn on Airplay (Fig3/4)

Note: If you have connected Carplay before, you need to disconnect Carplay first!



Wired Autolink connection

1. Download Android auto APP on your Android phone(Fig.1).
2. Click 'Autolink' icon(Fig.2), the prompt 'Please connect your Android device' will pop up(Fig.3).
3. Plug your phone to USB port(Fig.4). then it will enter Android auto automatically(Fig.5).

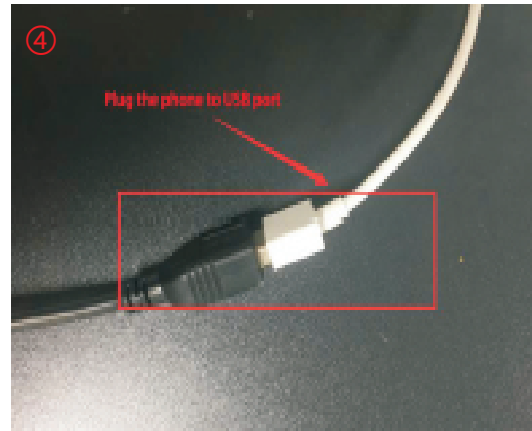
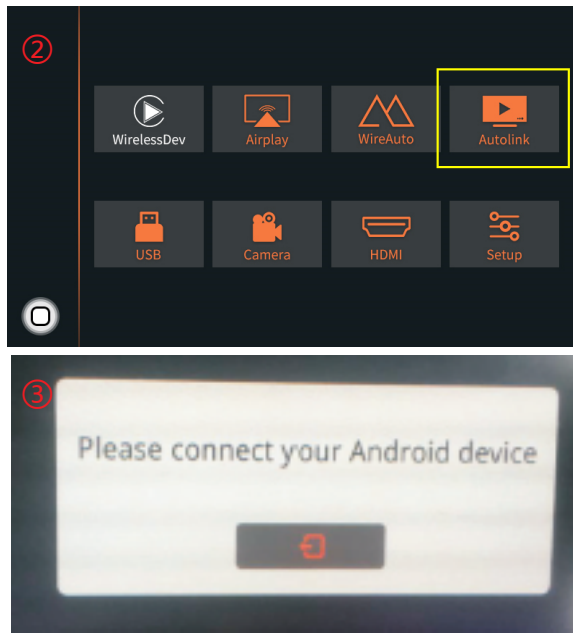
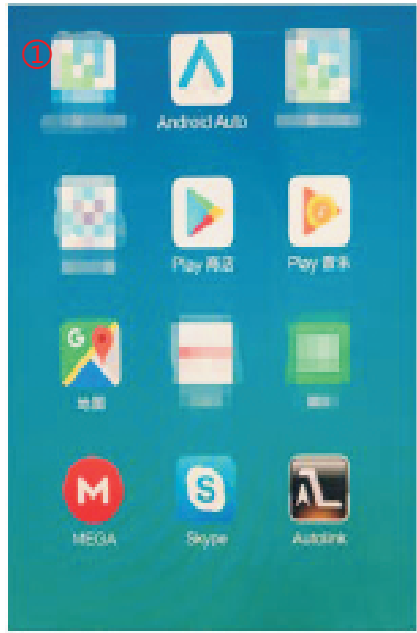

Setting instruction:

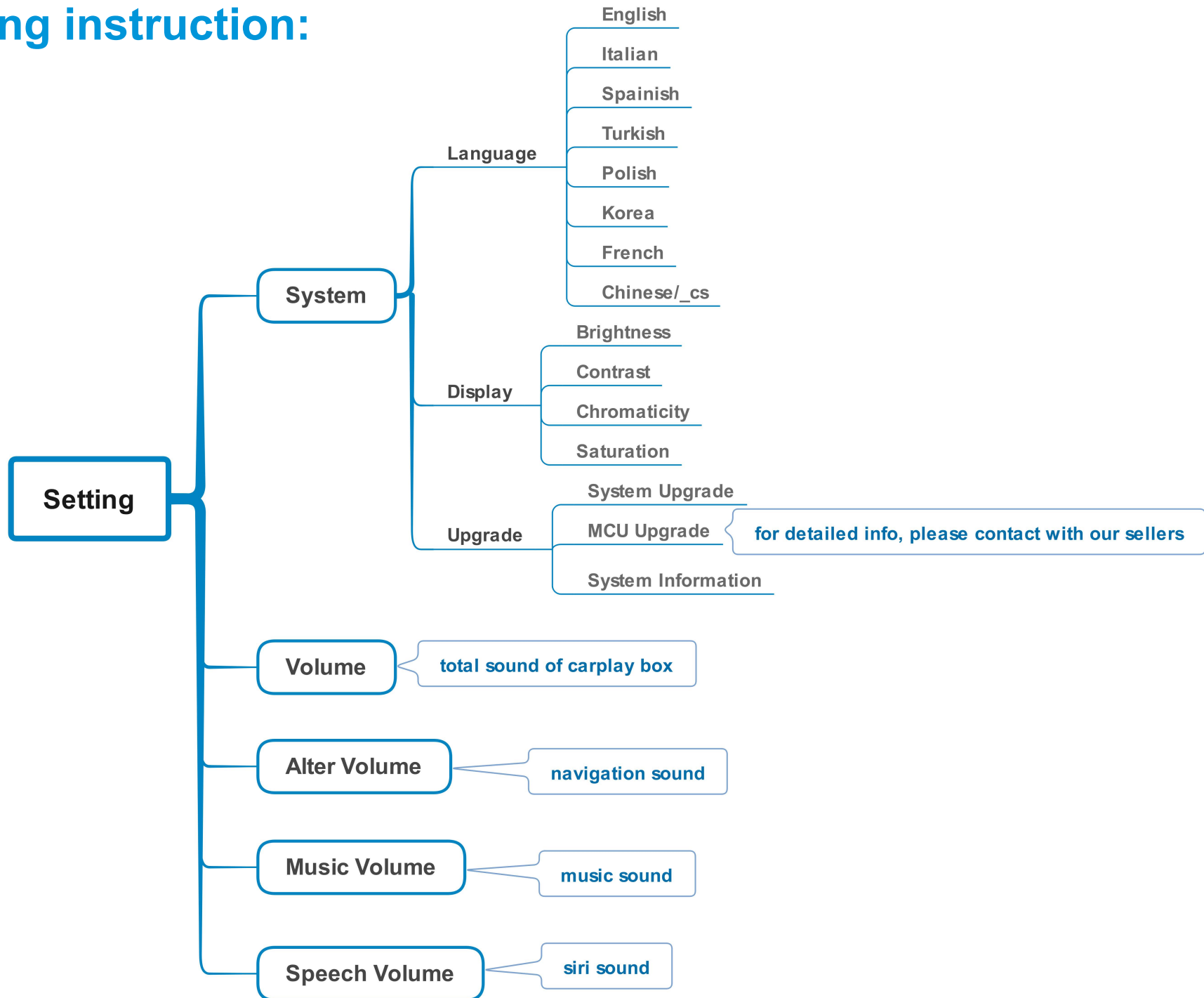

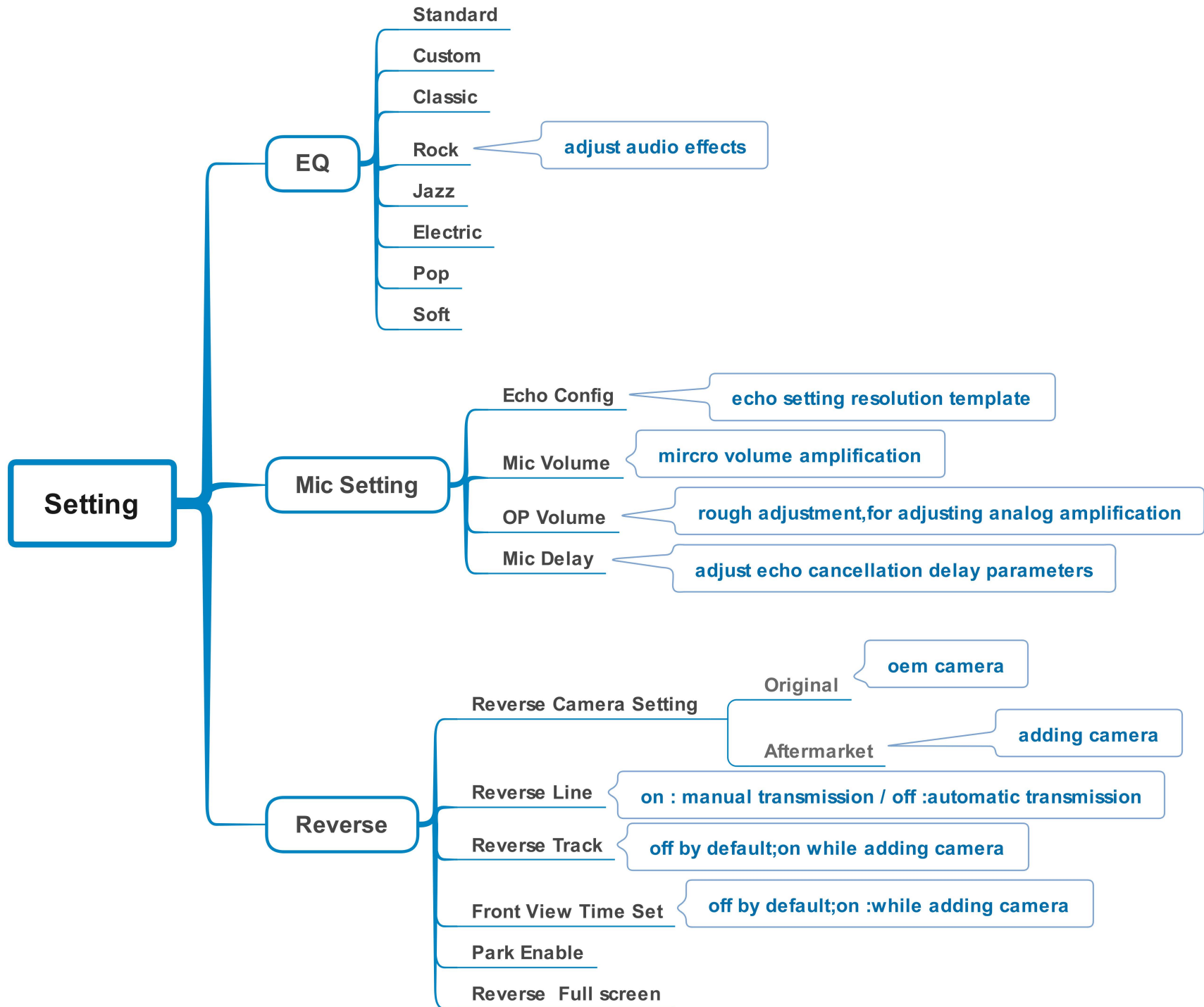

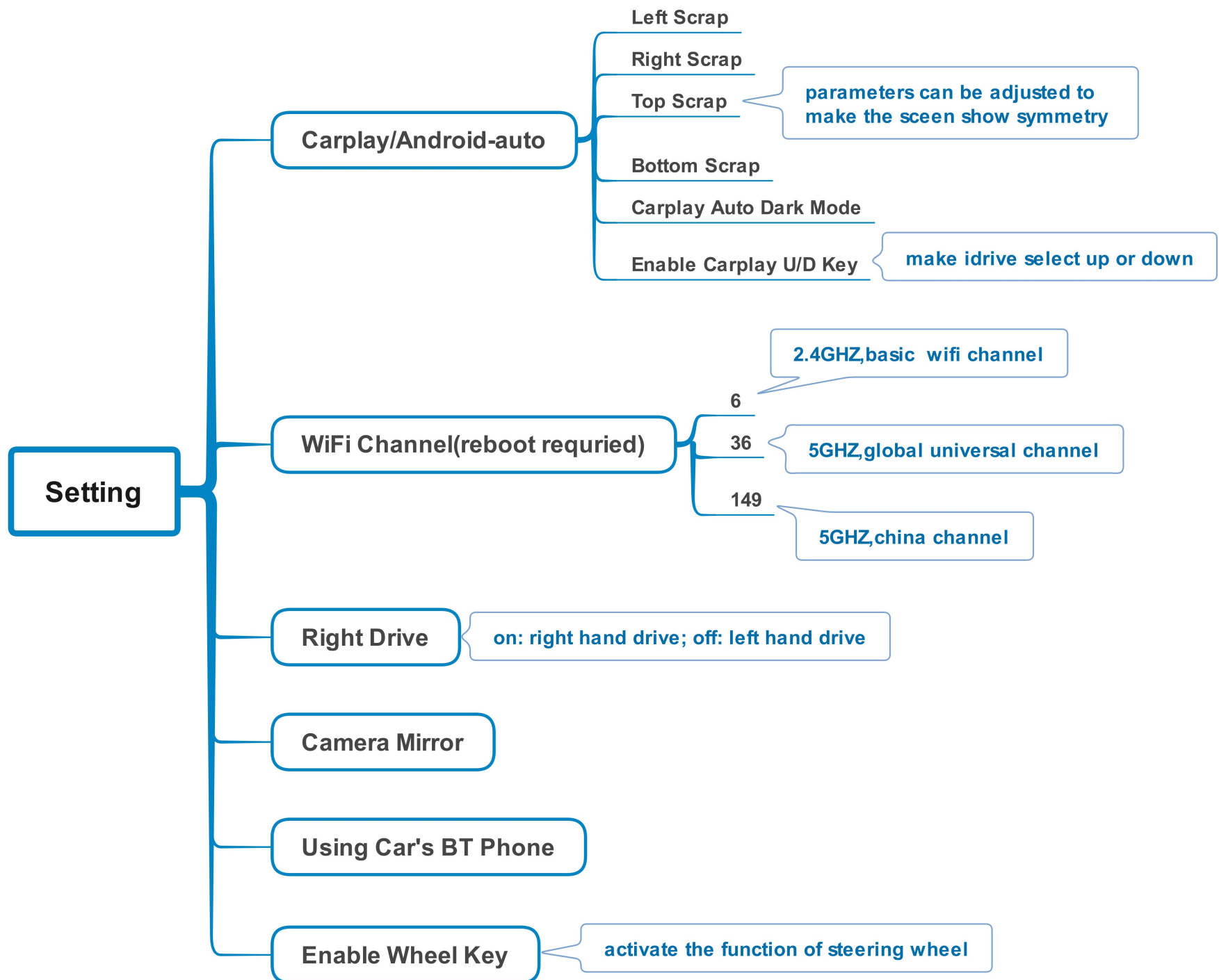



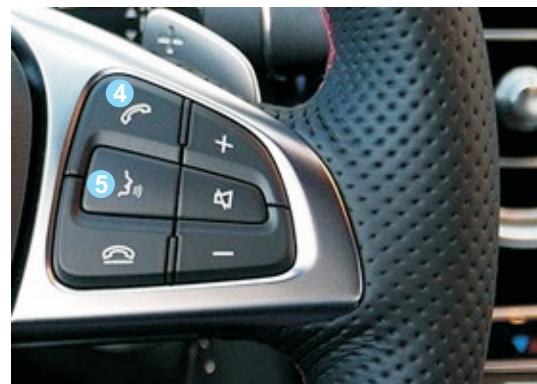





Original buttons

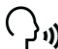

Button	Function	Operation	Remarks
1 C/★	System switching	Long press the button for 3 seconds	OEM ↔ CarPlay
2 Back	Go back	Press the button short time	Apple Car Play Function 
	Restart	Press the button 5 seconds	Google Android Auto  You can use this function when you get in trouble
3	Move the pointer Left or Right	Turn the dial Move Left or Right	Apple Car Play Function 
			Google Android Auto 
4	Answer/hang up the call	Press the button short time	Apple Car Play Function 
			Google Android Auto 
5 	"Siri" "Google Assistant"	Press the button 3 seconds	Apple Car Play Function 
			Google Android Auto 

FAQ

1.Q: What need to be paid attention to during installation?

- A: 1) Make sure that the carplay box is compatible with the installed model, and check whether the label of box matches with the car model.
2) Power off during installation
3) After the installation is complete, it is best to lock the car for a few minutes to turn it on, wait until the running test is normal, then restore the car

2.Q: While switching to carplay, the screen displays no signal, black screen, abnormal screen or no response?

- A: 1) Check whether the wiring is connected according to the wiring diagram
2) If the wiring connection is normal but the display is not normal, check if the pins of the lvds cable ports are bent or not in contact, you need to re-plug it.
3) Check whether the dip switch code is correct, after each change, re-plug the box's can power cable .
4) If the dip switch code and wiring connection are normal after inspection, box still switches to the black screen, contact with the saler for a solution

3.Q: I don't have sound when I connect carplay, what can I do?

- A: 1) if car has original car fiber optic cable ,transfer first
2) if the car is NTG4.5 system, you need to activate AUX first
3)for NTG 5.X, you can connect the USB-to-AUX audio cable to get sound(for detail, please refer the connection)

The video to activate AUX for NTG4.5: https://youtu.be/_ye5OO6r1IY

4.Q:For Benz 5.x ntg which has no Burmester , how to install the amplifier box?

- A:1) Plug the power amplifier box into the corresponding socket on the power cord.

Note: Amplifier box should not be placed together with the box.

- 2) Connect the audio ground cable from the power cord to the USB ground cable, and the sound will be normal.
3) Refer to the installation diagram of 4.5/5.0 box for other installation process.

5. Q: Solutions to not being able to connect with carplay?

A: can try to use the solutions below separately or together

- 1) Click on carplay bluetooth or wifi on the mobile phone
- 2) At the same time, clear the Bluetooth devices on the mobile phone and the car, and then pair and connect
- 3) Go to WirelessDev to reset the Bluetooth, and then pair and (Fig.1)

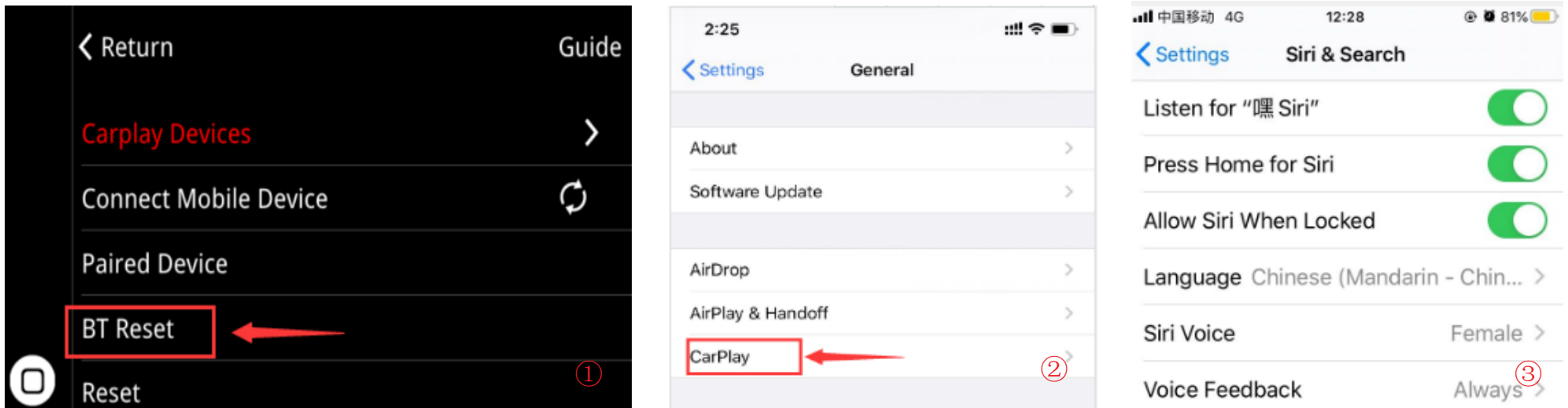

- 4) Restore the mobile network to the mobile phone
- 5) Check whether the carplay on the mobile phone is turned on (Fig.2)
- 6) Siri permissions are all turned on(Fig.3)
- 7) If necessary, check the antenna (whether it is broken, or attached to the metal, stay away from the box)

6.Q:When I call someone, he can hear himself, how to do?

A:1) Adjust the volume of the original car to normal use

2) Turn the volume in 'audio' setting to 13(Fig.1)

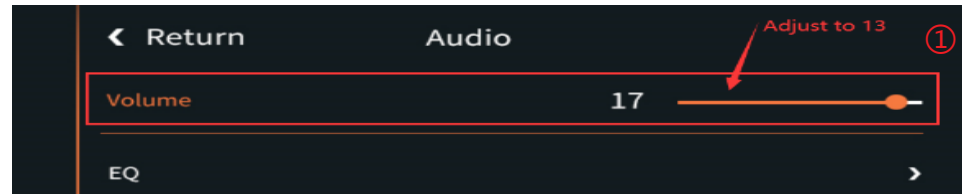

3) Turn the 'Microphone Volume' to 12

4) 'Microphone OP' tune from 0 until no echo is heard

5) Adjust 'AEC quality' to 2

6) If the caller hears the echo interval for a long time, fine-tune the 'Microphone delay'

7) If the caller hears a small voice, you can fine-tune the 'Microphone Volume' and 'Microphone PGA'

7.Q:I install the carplay, but the button on steering wheel can't work A:

A:Set the setting 'Enable wheel key' to ON(Fig.2)

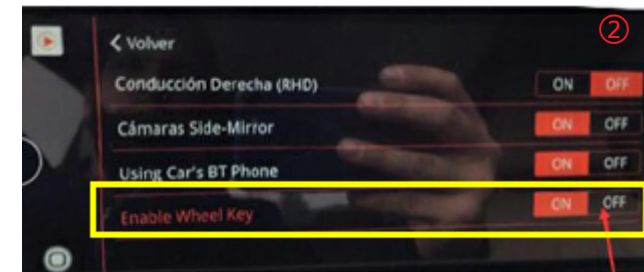

8. Q: Siri function can not be used.

A: 1) Check whether has turned the siri access permissions on iphone,turn all the options on

2) Turn the function of steering wheel on in carplay switch page setup

3) If can activate the Siri but Siri cant receive the command, please check whether the mic works first, if no problem with mic, check the Bluetooth of iphone, disconnect it from original car Bluetooth